

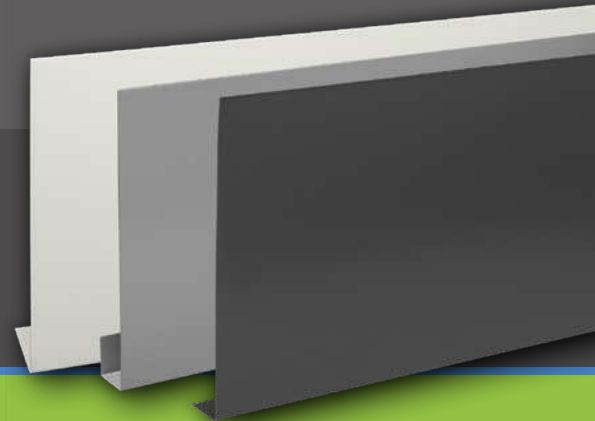

INFINITY GALVANISED STEEL  
FASCIA & SOFFIT SYSTEM  
2020



*The future of roofline*





Aesthetically pleasing and robust, the unique option for colour matching Infinity Rainwater Systems



## Welcome

The Infinity roofline system is an engineered fascia & soffit system designed to last, it offers designers, architects and home owners a unique option for colour matching the fascia and rainwater system.

The superior finish of Infinity gives a soft sheen that is both aesthetically pleasing and robust. Made from pre-coated galvanised steel material, the system is UV and scratch resistant, providing colour stability for the long-term. Backed by a 15 year product warranty, the Infinity roofline systems offers peace of mind for installers and home owners.

*The future of roofline*

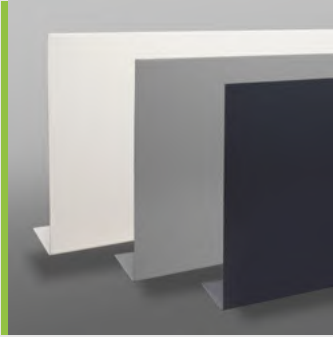

### MODERN V – Profile

The V profile gives a crisp, modern edge to the fascia, more suitable for a contemporary building design.

See page 5



### TRADITIONAL U – Profile

The U profile is typical of a traditional style fascia; it provides a shadow line to the fascia that adds character to the roofline.

See page 6

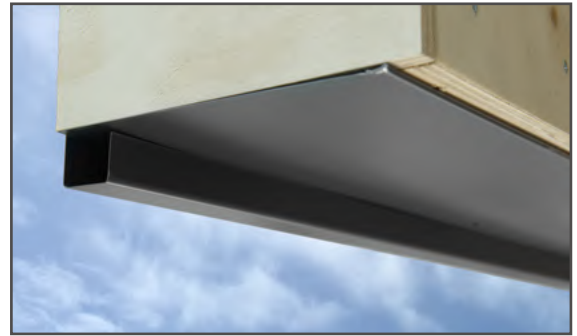

### CLASSIC L – Profile

The classic L profile finishes flush underneath the soffit to give a classic box style finish to the soffit.

See page 7



## The Infinity System



### Simplicity by Design

The Infinity system has been designed with simplicity in mind, with just four base components, it is straightforward and simple to install, components can be overlapped, eliminating the need for awkward measuring and cuts.

#### Key Features

- UV resistant colour coated finish with 15 Year Product Warranty
- 'Robust' scratch resistant coating with protective film for added protection during installation
- Simply overlap joints for a neat, hassle free installation.
- Self-adhesive universal corner pieces
- Simply fix using, colour-match capped, stainless steel, ring shanked nails
- Engineered to give an exceptional finish and designed for fast and effective installation

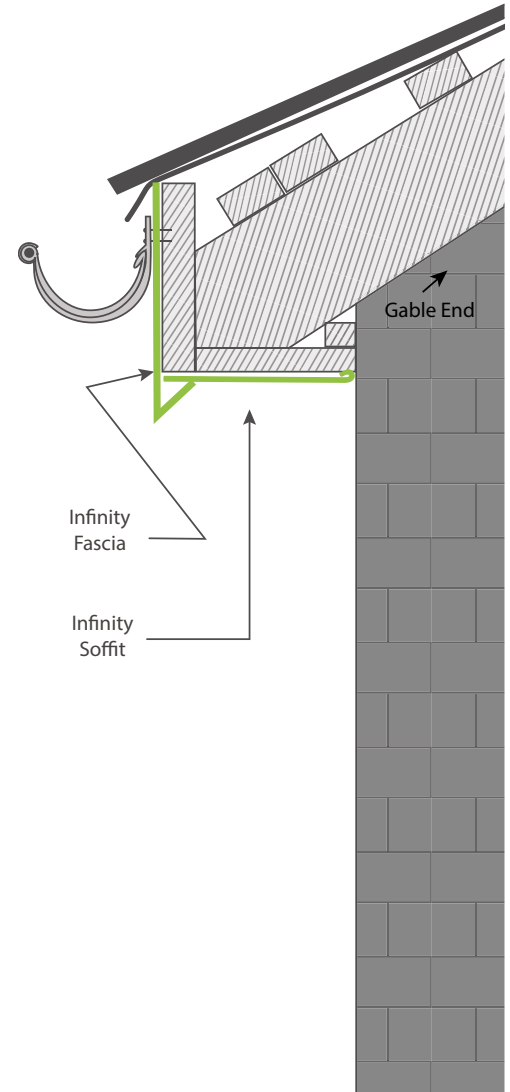

## Robust 4 layer colour coating

The innovative and extremely hard wearing colour coating used on the Infinity Galvanised Steel Fascia & Soffit System consists of four layers of protection comprising; a galvanised steel core, zinc/magnesium corrosion protection, primer bonding coat and a robust polyester top coat.

The surface coating is UV and scratch resistant and has been formally performance tested to be:

- Scratch resistant to  $>_{30}$  N in accordance to EN123523-12-2004
- UV resistant RUV 4 in accordance with EN10169-2



- 1 Galvanised steel core
- 2 Zinc / Magnesium corrosion protection layer
- 3 Primer bonding coat adds further corrosion protection
- 4 Polyester top coat for maximum UV and scratch resistance

## Stock colours

RAL 7016M	Anthracite Grey	
RAL 7037M	Dusty Grey	
RAL 9002M	Grey White	
<b>COMING SOON! CALL 0800 644 4428</b>		
RAL9016	White	

Stock colours are available for next day delivery

## Additional colours

Galvanised		
RAL 9005M	Black	
RAL 8019M	Sepia Brown	

Additional colours are available to order and may be subject to longer lead-times and colour surcharges, please enquire with our customer service team on **0800 644 4428**

N.B. Colours are reproduced for general guidance only.

For exact colour and finish references, please contact Infinity for colour swatch samples and for further information.

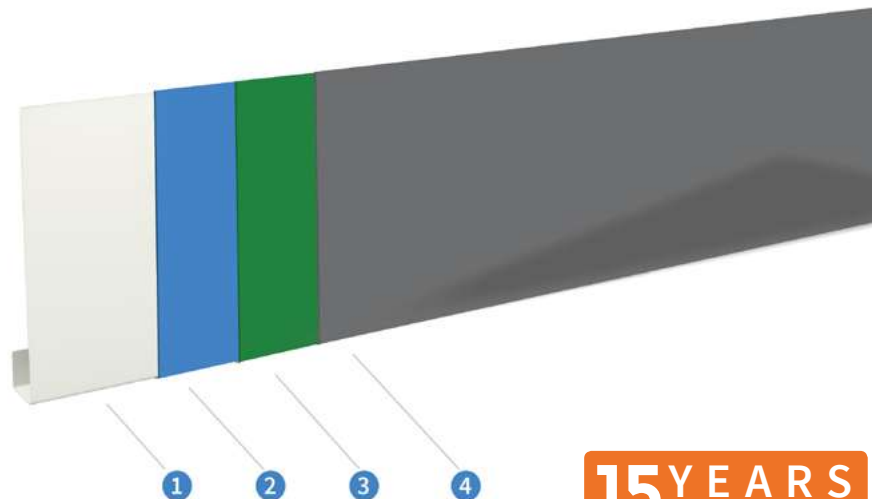

**15 YEARS**  
PRODUCT WARRANTY

# INFINITY GALVANISED STEEL FASCIA & SOFFIT SYSTEM

## 3m Fascia - Modern V Profile

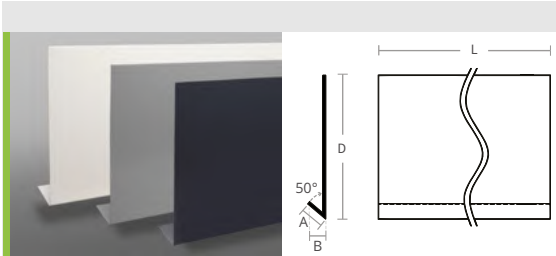

Size	A	B	D	L
150mm	37mm	32mm	150mm	3m
175mm	37mm	32mm	175mm	3m
210mm	37mm	32mm	210mm	3m
260mm	37mm	32mm	260mm	3m

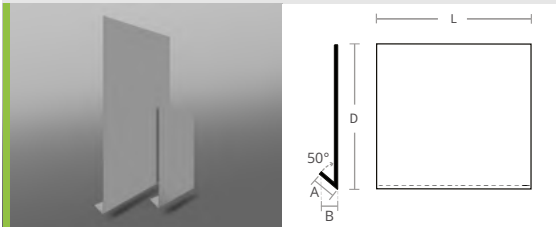

Size	A	B	D	L
400mm	37mm	32mm	400mm	400mm
600mm	37mm	32mm	600mm	600mm

### 3m Fascia - Modern V Profile



	Anthracite Grey	Dusty Grey	White Grey
150mm	FSV150AG	FSV150DG	FSV150WG
	£67.97		
175mm	FSV175AG	FSV175DG	FSV175WG
	£81.56		
210mm	FSV210AG	FSV210DG	FSV210WG
	£81.56		
260mm	FSV260AG	FSV260DG	FSV260WG
	£105.12		

### Gable End - Modern V Profile

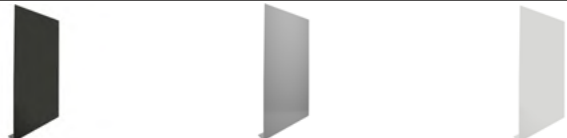

	Anthracite Grey	Dusty Grey	White Grey
400mm	FSVG44AG	FSVG44DG	FSVG44WG
	£51.85		
600mm	FSVG66AG	FSVG66DG	FSVG66WG
	£87.90		

## 3m Fascia - Traditional U Profile

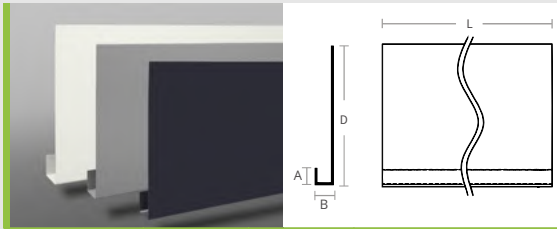

Size	A	B	D	L
155mm	27.5mm	30mm	155mm	3m
200mm	27.5mm	30mm	200mm	3m
255mm	27.5mm	30mm	255mm	3m

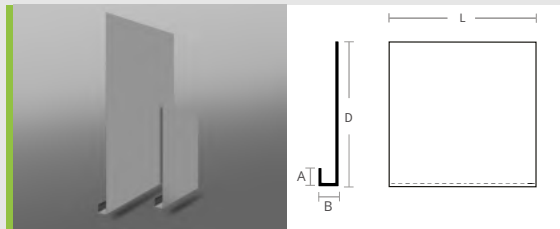

Size	A	B	D	L
400mm	27.5mm	30mm	400mm	400mm
600mm	27.5mm	30mm	600mm	600mm

## 3m Fascia - Traditional U Profile



	Anthracite Grey	Dusty Grey	White Grey
155mm	FSU155AG	FSU155DG	FSU155WG
	£67.97		
200mm	FSU200AG	FSU200DG	FSU200WG
	£81.56		
255mm	FSU255AG	FSU255DG	FSU255WG
	£81.56		

## Gable End - Traditional U Profile



	Anthracite Grey	Dusty Grey	White Grey
400mm	FSUG44AG	FSUG44DG	FSUG44WG
	£5185		
600mm	FSUG66AG	FSUG66DG	FSUG66WG
	£87.90		

# INFINITY GALVANISED STEEL FASCIA & SOFFIT SYSTEM

## 3m Fascia - Classic L Profile

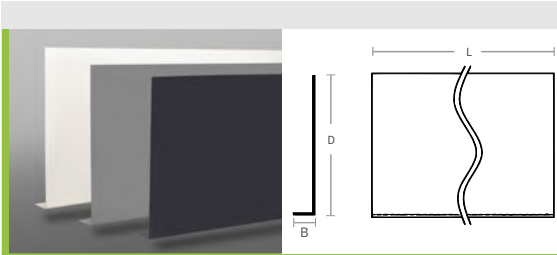

Size	B	D	L
150mm	31mm	150mm	3m
175mm	31mm	175mm	3m
210mm	31mm	210mm	3m
260mm	31mm	260mm	3m

## 3m Fascia - Classic L Profile



	Anthracite Grey	Dusty Grey	White Grey
150mm	FSL150AG	FSL150DG	FSL150WG
	£67.97		
175mm	FSL175AG	FSL175DG	FSL175WG
	£81.56		
210mm	FSL210AG	FSL210DG	FSL210WG
	£81.56		
260mm	FSL260AG	FSL260DG	FSL260WG
	£105.12		

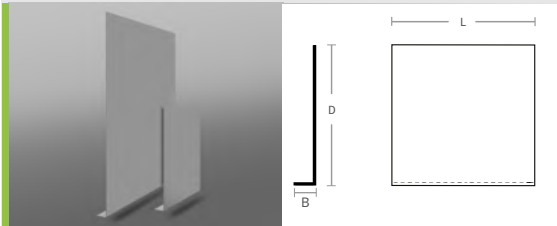

Size	B	D	L
400mm	31mm	400mm	400mm
600mm	31mm	600mm	600mm

## Gable End - Classic L Profile



	Anthracite Grey	Dusty Grey	White Grey
400mm	FSLG44AG	FSLG44DG	FSLG44WG
	£51.85		
600mm	FSLG66AG	FSLG66DG	FSLG66WG
	£87.90		



## Soffits and Corners

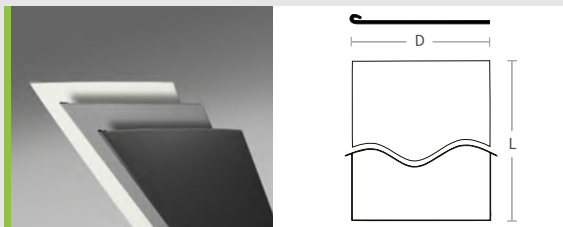

Size	D	L
100mm	100mm	3m
150mm	150mm	3m
175mm	175mm	3m
210mm	210mm	3m

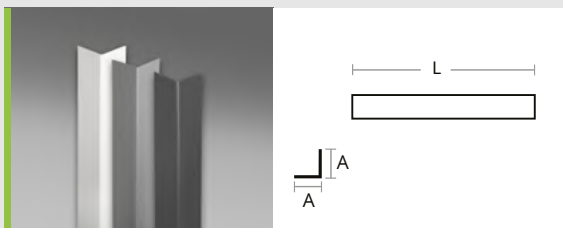

Size	A	L
500mm	35mm	500mm

### 3m Soffit

	Anthracite Grey	Dusty Grey	White Grey
100mm	FSS100AG	FSS100DG	FSS100WG
	£55.37		
150mm	FSS150AG	FSS150DG	FSS150WG
	£85.57		
175mm	FSS175AG	FSS175DG	FSS175WG
	£85.57		
210mm	FSS210AG	FSS210DG	FSS210WG
	£105.71		

### Universal Angle Trim

	Anthracite Grey	Dusty Grey	White Grey
500mm	FSA500AG	FSA500DG	FSA500WG
	£24.98		

## Fixing Accessories



### Fixing nails



	Anthracite Grey	Dusty Grey	White Grey
Pack of 250 Small 2.0 x 25mm	NS25AG	NS25DG	NS25WG
	£35.10		



	Anthracite Grey	Dusty Grey	White Grey
Pack of 100 Large 3.2 x 40mm	NL40AG	NL40DG	NL40WG
	£31.81		

### Silicone Sealant



	Clear
300ml	FSEALCL
	£12.03

## Fixing Accessories



### Touch-up Paint



Anthracite Grey	Dusty Grey	White Grey
AGSTSPRAY	DGSTSPRAY	WGSTSPRAY
£23.34		



### Adhesive Tape - 25m



Water impermeable tape on a 25metre roll.  
**N.B. The Universal Angles come with the tape pre-applied** - see installation guidance on pages 13-16 for where adhesive tape is required.

25metre	FSTAPE
	£38.44

## Product Selection and Preparation



*Before*



*After*

The Infinity fascia & soffit system is an 'over fascia' and must be fixed onto a sound wooden substrate. On a new build, simply install a wooden fascia as normal, then over clad with Infinity.

For a refurb project, ensure that the existing fascia is sound and free from rot, replace any sections if needed and treat any existing wood with wood preservative, once this has been done and the substrate is sound, then simply over clad with Infinity.

Call **0800 644 4428** now or visit [www.infinityguttering.co.uk](http://www.infinityguttering.co.uk)

## Product Selection and Preparation

### 1. Substrate

Ensure that there is a suitable structural wooden substrate installed, it is recommended that the substrate is minimum of 25mm thick and sound.

### 2. Choose fascia profile

Choose the profile design required from the options on page 2.

### 3. Choosing the correct size

Measure the existing fascia & soffit and pick the closest Infinity Galvanised Steel fascia and soffit size increment to suit your project.

**Note:** Infinity Fascia & Soffit can be cut to suit on site with cordless metal shears (see page 13)

### Before you start



- Tape measure
- Square
- Bevel
- Clamps
- Hammer
- Pencil & marker pen
- Level
- Metal Snips
- Metal shears/nibbler
- Gloves & goggles
- Work bench

### Installation Do's

- Use a pencil to mark cuts and avoid leaving pencil marks on visible surfaces.
- Only cut using a hand-held metal shears or mechanical nibbler (Makita Cordless Shear DJS161 or similar recommended).
- Overlap joints and where possible use the factory cut edge on top.
- Use Infinity colour matched, stainless steel ring shanked nails only.
- Galvanised Steel is not suitable for marine or coastal environments where there is risk of salt air.
- Take care when handling longer lengths and adequately support 3m lengths during cutting and handling.
- Take care with sharp cut edges and use appropriate gloves to avoid cuts.
- Always use rubber headed hammers when working on the coated surfaces.
- Use Infinity touch-up paint on all cut edges.
- Care should be taken when working at height, observe your working environment and ensure that site safety equipment is used.

### Installation Don'ts

- Do not leaving pencil marks on visible surfaces.
- Do not under any circumstance use a mechanical grinder or hacksaw to cut Infinity, this will damage the galvanised core and result in potential rusting of cut edges which will invalidate the product warranty.
- Do not use steel or zinc plated fixing as this may result in rust run-off and decolouring of the coating.
- Do not use marker pen on visible surfaces as this will be difficult to remove.
- Do not use metal hammers on the products as this may result in damage to the coated surfaces and unnecessary scratching.

## Installation

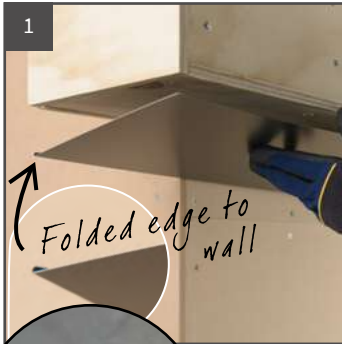

### Soffit

The soffit must be installed first. The soffit is 3m long and has a folded return edge along one side, this is to give it rigidity at the wall edge.

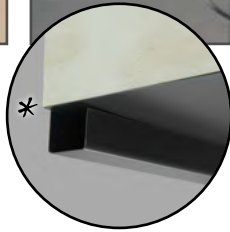

### Cutting the Soffit to the correct width

The soffit can be easily cut to the right width using a metal nibbler or shears. The cut edge of the soffit will eventually sit in under the fascia edge so interface between the fascia and soffit usually allows for an element of tolerance in the cutting\*.

### Top Tip

Mark the soffit along its edge and lay it flat on a piece of wood at bench height to support the full length, clamp it at one end to make cutting easy.

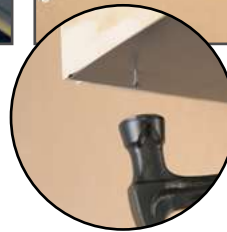
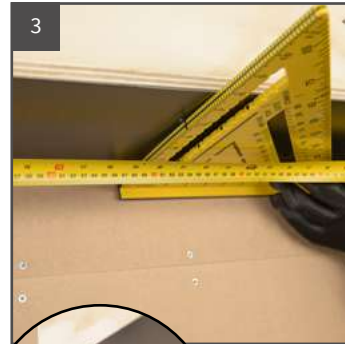

### Fix Soffit

Once cut to the correct width, fix the soffit with a minimum of 2 nails (approx 30mm from both width-wise edges) at 500mm intervals along the length using the colour-matched, Infinity ring shanked stainless steel nails as shown.

### Top Tip

Pre-drill the nail spacing using 2mm drill bit to make nailing a breeze.



### Overlap Soffit

Continue to install the soffit along the entire length of the building, overlapping each joint by a minimum of 25mm. For ease of installation, use Infinity adhesive tape at each joint to help hold the overlap in place while fixing.

### Top Tip

Get someone to help hold up one end while you line-up and nail in the right position.

### Top Tip

Care should be taken when handling the soffit to avoid kinking the folded edge.

## Installation

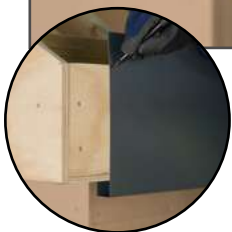

### Fascia

Once the soffit is installed, proceed to fix the fascia. First offer the fascia up into place and ensure that the underside inside edge abuts to the soffit. If there is a gap, it is likely that the fascia will need trimming along its length to allow this gap to close. Variation in the substructure is to be expected so adjust each fascia section accordingly to accommodate any variance.

### Top Tip

Measure twice, cut once!



### Fix Fascia

Fix the fascia with a minimum of 2 nails at 750mm intervals along the length using Infinity ring shanked stainless steel nails as shown.

Note: All joints must be fixed through using 25mm ring shanked stainless steel nail as shown above.

### Top Tip

Ensure fixings are positioned to fix securely into the wood substrate. It's recommended the fixings are a minimum of 25mm from the edge of the sub-fascia timber. Pre-drill the nail spacing using 2mm drill bit for ease of nailing.



### Overlap Fascia

Continue to install the fascia along the entire length of the building, overlapping each joint by a minimum of 25mm. For ease of installation, use Infinity adhesive tape at each joint to help hold the overlap in place while fixing.

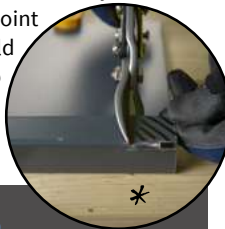

### Top Tip

On the 'U' profile it is recommended that you cut away a section as shown above, to ensure the overlap will sit flush.

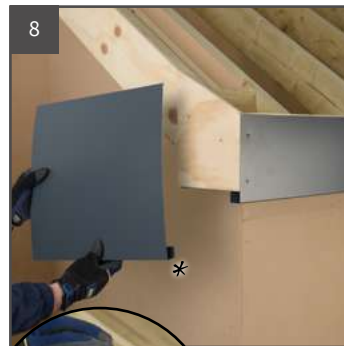

### Gable Box End

For the gable box end, choose the correct sized gable box to suit your installation (choose from 400x400 or 600x600). Mark and cut the gable box end to size as shown.

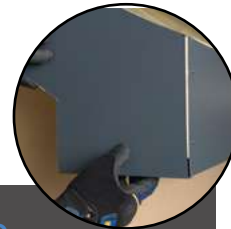

### Top Tip

Cut the Gable box in such a way that the Gable-End Barge Board overlaps it to give a weatherproof lap (see fig. 10)

## Installation

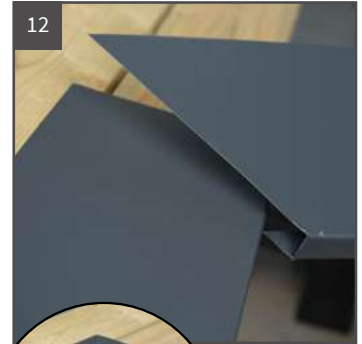
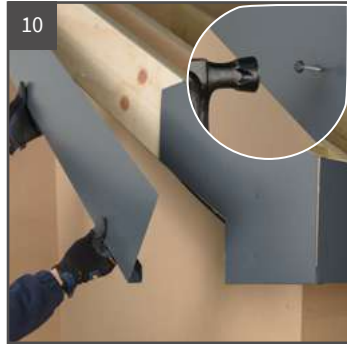

### Gable-End Barge Soffit

First fix the underside soffit board up the gable end (follow previous instruction points 1-4 overleaf).

Once the soffit board is installed, proceed to fix the barge board following the same principle used to fix the fascia (points 5-7 overleaf) overlapping each joint by min. 25mm. Fix the barge over fascia using the larger 40mm nails. At the intersection between the gable box and the barge board, simply overlap the barge fascia over the gable box as shown.

Fit the gable from bottom to top, this is important so that the overlap direction is weatherproof. Fix at 750mm centres using the larger fixing nail (3.2mm x 40mm).

At the ridge, it is recommended to cut the profile so as to overlap the joint. The best way to achieve this is to run one gable through, then overlap with the opposite side. Once in position, fix the joint using 3.2 x 40mm nails

### Top Tip

Work from bottom to top, overlapping each joint to create a weatherproof join.

### Top Tip

Some prefer to see a plum cut here so, if you prefer, simply mark and cut the profile using a metal nibbler or shears.

### Top Tip

Pre-drill the nail spacing using 3mm drill bit to make nailing a breeze. Position the fixings at equal positions and preferably at plumb-line for that professional touch!

### Top Tip

Cut the overlapping piece with a plumb cut for that professional touch.



## Installation



### Measuring the Corner Trim

All corners can be finished using the universal corner trim. Offer the trim up to the corner as shown. Mark the length required, add 25mm to this length and cut to length. Using the original mark, cut a V shape in the corner.



### Fixing the Corner Trim

With the trim cut as shown in 13, offer the trim up to the gable corner to check its length.

At this stage it should protrude 25mm below the fascia.

Remove the protective cover from the self-adhesive tape and press firmly into place.

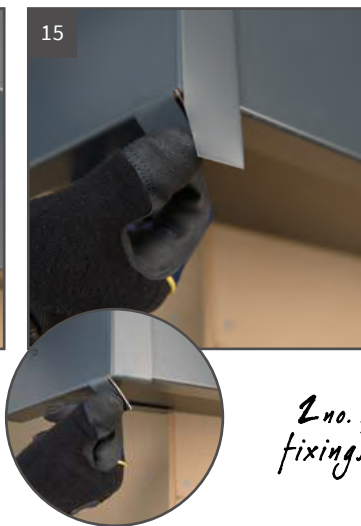

Bend the bottom of the trim to close off the bottom, overlapping as shown.

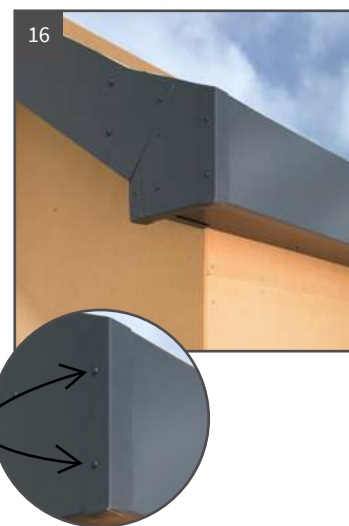

Once in position, fix using nails (minimum 2no recommended on the gable end).

### Top Tip

Use a hand metal shears for accuracy and easy of use.

### Top Tip

Use a small rubber mallet to create a crisp tight fold.



## RAINWATER SYSTEMS

The Infinity roofline system is manufactured in Germany using the latest in material and manufacturing technology.

The Infinity range is a result of decades of continued innovation in galvanised steel, copper and zinc rainwater systems. The systems comes with a 15 year product warranty.



- The deep-flow half round profile has exceptional capacity offering peace of mind for effective rainwater disposal
- Dry jointed union connectors with no need for messy silicone
- Swaged downpipes that simply push-fit together
- A range of hopper heads, angles, branches, bends, offsets, outlets and brackets for a quick, easy to install gutter solution
- Fully galvanised with a robust 4 layer colour coating (see page 4) and available in a range of 6 finishes: Natural Galv, Black, Anthracite Grey, Dusty Grey, White, and Sepia Brown - PLUS real Copper & Zinc

- Easy to install dry-jointed rubber lined gutter union
- Push-fit stop-ends with EPDM rubber seal
- Fascia brackets with pre-formed security tabs
- Choice of wrap-around gutter outlets for complete flexibility or prefabricated for simplicity and speed

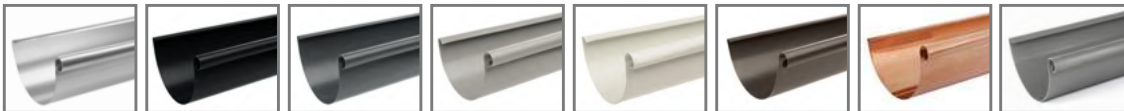

**15 YEARS**  
PRODUCT WARRANTY

# RAINWATER SYSTEM COMPONENTS

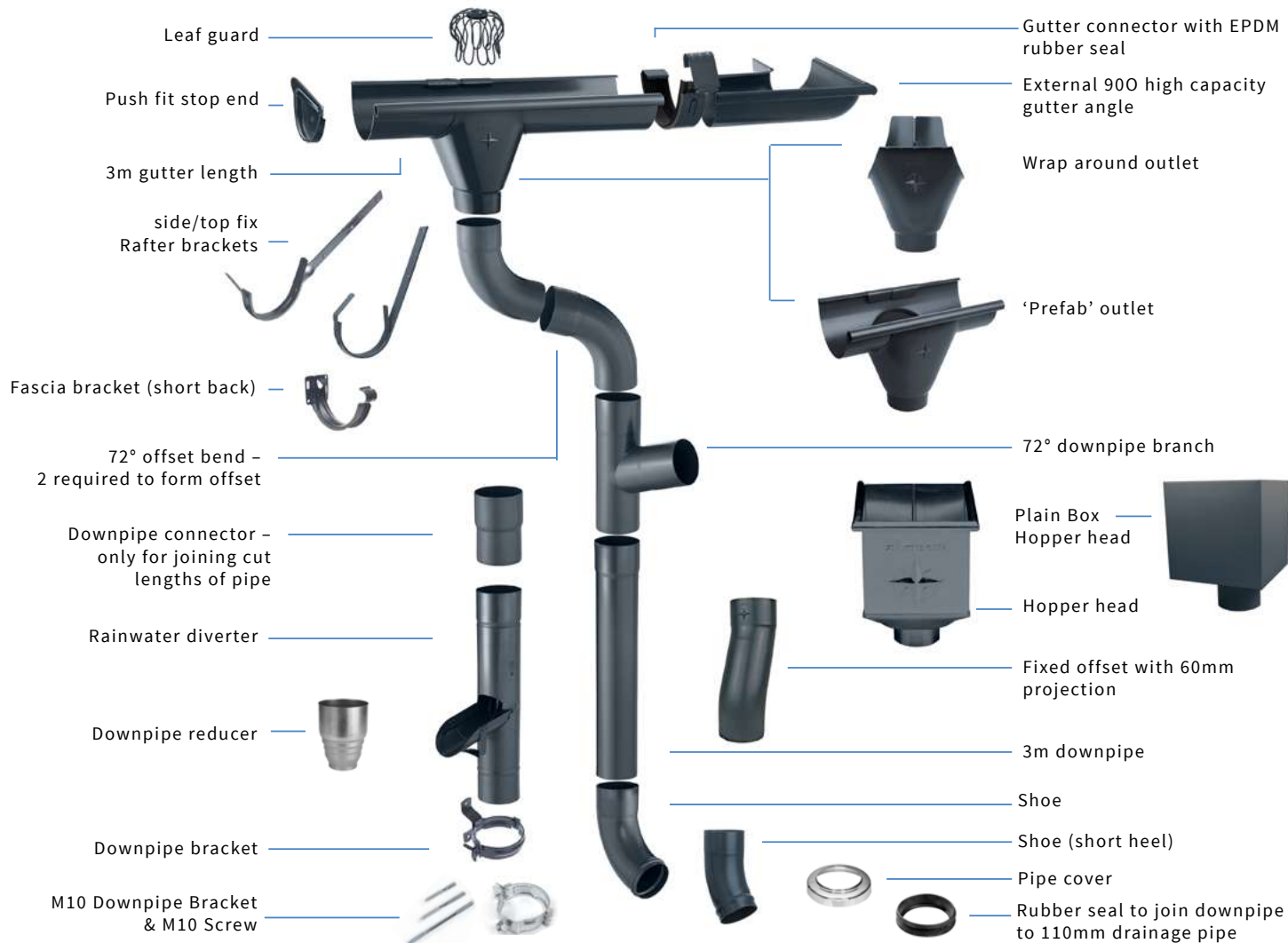



Unit 34A  
Techno Trading Estate  
Ganton Way  
Swindon  
Wilts  
SN2 8ES

T: 0800 644 4428  
E: [info@infinityguttering.co.uk](mailto:info@infinityguttering.co.uk)  
W: [www.infinityguttering.co.uk](http://www.infinityguttering.co.uk)

Your local stockist/installer

*The future of roofline*